

Overview of the 2017 National Training Institute

The 2017 National Training Institute (NTI) is provided by the National Adult Education Professional Development Consortium (NAEPDC). The agenda was developed by a planning committee comprised of adult educators from several states and in consultation with the Office of Career, Technical and Adult Education (OCTAE).

The session topics are designed to address WIOA implementation and include the following areas:

- Roles and Responsibilities of Adult Education as a Required One-Stop Partner
- Workforce Preparation as an Allowable Activity
- Integrated Education & Training (IET) and Integrated English Literacy & Civics Education (IELCE)
- Entrepreneurship Development and Implementation Models



Welcome to Charleston!

Additional Conference Information Available Online



<http://www.nasdae.org/>

2017 National Training Institute
November 14-17, 2017

NAEPDC/NCSDAE Executive Committee

Member	State	Position	Term Expiration
<i>Reecie Stagnolia</i>	<i>Kentucky</i>	<i>Chair</i>	<i>June 30, 2019</i>
<i>Beverly Smith</i>	<i>Georgia</i>	<i>Past Chair</i>	<i>June 30, 2018</i>
<i>Valerie Fischer</i>	<i>North Dakota</i>	<i>Treasurer</i>	<i>June 30, 2018</i>
<i>David Walters</i>	<i>Alabama</i>	<i>Representative</i>	<i>June 30, 2018</i>
<i>Sheryl Hart</i>	<i>Arizona</i>	<i>Representative</i>	<i>June 30, 2018</i>
<i>Alex Harris</i>	<i>Iowa</i>	<i>Representative</i>	<i>June 30, 2019</i>
<i>Art Ellison</i>	<i>New Hampshire</i>	<i>Representative</i>	<i>June 30, 2018</i>
<i>Sandy Crist</i>	<i>Mississippi</i>	<i>Representative</i>	<i>June 30, 2019</i>
<i>Philip Less</i>	<i>Rhode Island</i>	<i>Representative</i>	<i>June 30, 2019</i>
<i>Jon Kerr</i>	<i>Washington</i>	<i>Representative</i>	<i>June 30, 2019</i>
<i>Patricia Tyler</i>	<i>Executive Director</i>		
<i>Gene Sofer</i>	<i>Director, Government Relations</i>		

NTI Planning Committee:

<i>Sheryl Hart (Chair)</i>	<i>Arizona</i>
<i>Sandy Crist</i>	<i>Mississippi</i>
<i>Susan Fish</i>	<i>Oregon</i>
<i>Jennifer Foster</i>	<i>Illinois</i>
<i>Marcia Hess</i>	<i>Wyoming</i>
<i>Jacqueline Korengel</i>	<i>Kentucky</i>
<i>Philip Less</i>	<i>Rhode Island</i>
<i>Lennox McLendon</i>	<i>NAEPDC Emeritus</i>



Agenda-at a-Glance

NAEPDC

National Adult Education Professional Development Consortium National Training Institute • November 14-17, 2017

11/14 Tuesday	11/15 Wednesday	11/16 Thursday	11/17 Friday
<p>4:00 – 6:00 PM Early Registration <i>Hayne Street Gallery</i></p> <p>6:00 – 8:00 PM Networking Reception <i>Palmetto Courtyard</i></p>	<p>7:00 – 8:15 AM Registration & Breakfast <i>Hayne Street Gallery</i></p> <p>8:30 – 9:00 AM Welcome & Opening Session <i>Harleston/Wraggborough</i></p> <p>9:00 AM – 12:30 PM Session 1: Workforce Preparation Strategies & Options <i>Harleston/Wraggborough</i> (Note: this session has breakouts-please refer to the handout for your breakout assignment)</p> <p>12:30 – 2:00 PM Luncheon <i>Stono Ballroom</i></p> <p>2:00 – 5:00 PM Session 2: WIOA One-Stop Partnerships <i>Harleston/Wraggborough</i> (Note: this session has breakouts-please refer to the handout for your breakout assignment)</p> <p>6:30 – 9:00 PM Dinner Sponsored by Burlington English <i>The Rooftop at the Vendue</i></p> 	<p>7:00 – 8:45 AM Breakfast <i>Hayne Street Gallery</i></p> <p>7:30 – 8:45 AM NCSDAE/NAEPDC Business Meeting <i>Harleston/Wraggborough</i></p> <p>9:00 – 10:15 AM Session 3: NRS Performance Reporting <i>Harleston/Wraggborough</i></p> <p>10:30 AM – 12:00 PM Session 4: IET Implementation Options <i>Harleston/Wraggborough</i></p> <p>12:00 – 1:30 PM Luncheon <i>Stono Ballroom</i></p> <p>1:30 – 4:15 PM Session 5: IELCE <i>Harleston/Wraggborough</i> (Note: this session has breakouts-please refer to the handout for your breakout assignment)</p> <p>4:30 – 5:30 PM Special Focus Group for State Directors <i>Harleston/Wraggborough</i></p> <p>Dinner is on your own</p>	<p>7:00 – 8:15 AM Breakfast <i>Hayne Street Gallery</i></p> <p>8:30 – 11:30 AM Session 6: Entrepreneurship <i>Harleston/Wraggborough</i> (Note: this session has breakouts-please refer to the handout for your breakout assignment)</p> <p>11:30 AM Adjourn <i>Safe travels!</i></p>

Conference Hotel: Doubletree Hilton, Charleston, SC

Conference Room Rate: \$178 + tax

Conference Hotel Map

DOUBLETREE BY HILTON HOTEL & SUITES CHARLESTON - HISTORIC DISTRICT FIRST FLOOR

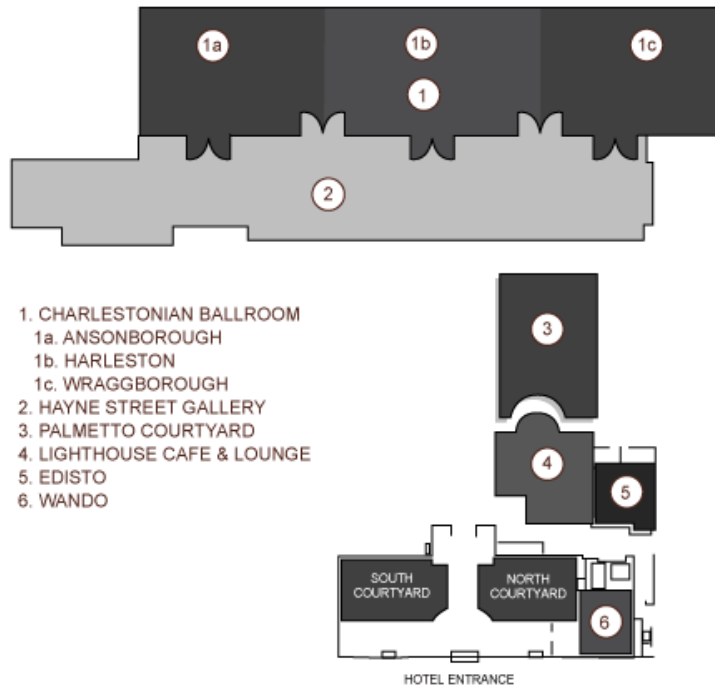

DOUBLETREE BY HILTON HOTEL & SUITES CHARLESTON - HISTORIC DISTRICT SECOND FLOOR

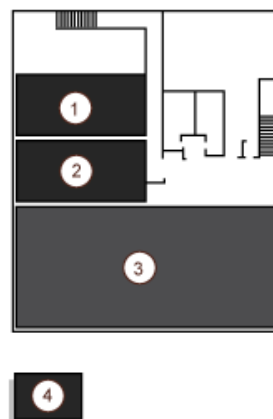

1. COOPER
2. ASHLEY
3. STONO BALLROOM
4. KIAWAH

We Appreciate the Support of Our Sponsors!



Special Sponsored Event

The Rooftop at Vendue!



Come join us for a fantastic, memorable dinner on Wednesday night, just steps from the conference hotel, at 6:30 pm. Proudly sponsored by



BURLINGTON ENGLISH®
THE PUBLISHER THAT CARES

www.burlingtonenglish.com/why-burlingtonenglish/

LACES

Literacy, **A**dult & **C**ommunity **E**ducation **S**ystem

IMPROVES HOW YOU RUN YOUR AGENCY

EASILY SET BASELINES * TRACK PROGRAM PROGRESS * DELIVER HIGH-QUALITY RESULTS
STREAMLINE DATA * POWERFUL WIOA REPORTING FUNCTIONS * SAFE & ACCESSIBLE CLOUD-OPERATED



COMMUNITYPRO SUITE

Inter-Agency Case Management

IMPROVES HOW YOU COLLABORATE WITH OTHER AGENCIES

COMBINE GOLDEN RECORD * COMMON APPLICATIONS * COMMUNITY CATALOG OF SERVICES & CLASSES
ELIGIBILITY MATCHING * REFERRALS & CASE MANAGEMENT * OUTCOMES REPORTING



www.literacypro.com
415.497.9409

LPS LiteracyPro
SYSTEMS



TEST
ASSESSING
SECONDARY
COMPLETION™

www.datarecognitioncorp.com



Building the educated and employed
communities of tomorrow

Our goals are simple: Open up doors to better paying jobs, new careers, college classrooms, and a brighter future. Together with educators, administrators, legislators, and employers, we will transform our high school equivalency program into a lifelong learning opportunity.

www.gedtestingservice.com